

# Repair Parts

**MODEL** 

## SST M-Group

Effective February, 1994



**SST-C**



**SST-F**

# Pump End Parts For Close-Coupled or Frame Mounted Configuration

For: M-Group power frame individual parts  
see M-Group Power Frame repair parts page

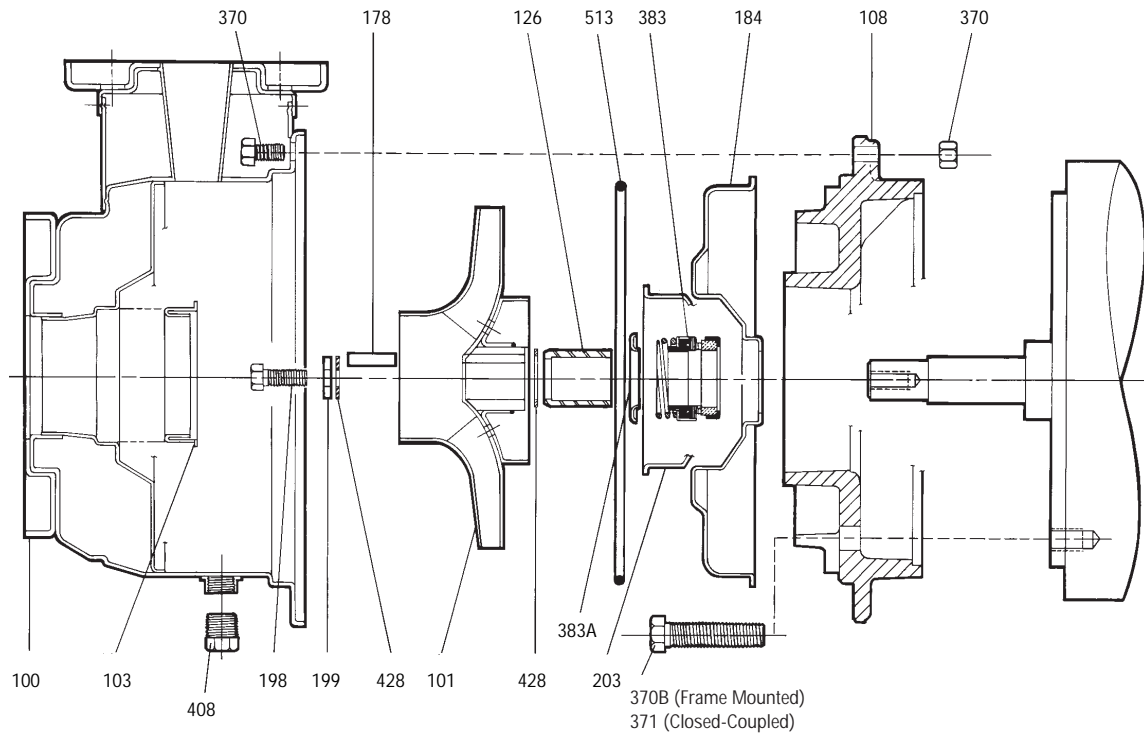

Note: For pump end parts for close-coupled with (140JM, 180JM, 210JM) see page 2.  
For pump end parts for close-coupled with (250JM-360TCZ) and all frame mounted configuration see page 3.

## FASTENER SIZING KEY - (NOMINAL SIZE /TYPE/LENGTH)

13L40	1/2" Hex head x 2 1/4" lg.
13L43	3/8" Hex head x 2 1/4" lg.
13L86	1/2" Hex head x 1 1/4" lg. with 1/2" nut
13L87	5/8" Stud x 1 7/8" lg. with 5/8" nut
13L88	1/2" Hex head x 3 1/4" lg.
13L89	3/8" Hex head x 1 1/4" lg. with 3/8" nut
13K213	1/2" Hex head x 3" lg.

# Pump End Parts For Close-Coupled With (140JM, 180JM, 210JM)

Item No.	Description	Material	8" Impeller Models			10" Impeller Models				Max. Wt. (lbs.)
			2 x 2 1/2-8	2 1/2 x 3-8	3 x 4-8	1 1/4 x 2-10	1 1/2 x 2 1/2-10	2 x 2 1/2-10	2 1/2 x 3-10	
			Part No.	Part No.	Part No.	Part No.	Part No.	Part No.	Part No.	
100	Casing with wear ring	AISI Type 304 SS	1L109	1L110	1L111	1L101	1L102	1L103	1L105	17
101	Impeller	AISI Type 304 SS (Shaded areas are AISI Type 316 SS)	8 5/8 2L621 8 7/16 2L622 7 7/8 2L623 7 1/2 2L625 6 11/16 2L652 6 1/2 2L653	9 1/16 2L673 8 1/2 2L675 8 1/4 2L676 7 7/8 2L677 7 1/8 2L679 6 11/16 2L680	9 1/16 2L667 8 7/16 2L668 8 1/16 2L669 7 1/2 2L670 7 1/8 2L671 6 1/2 2L672	10 1/16 2L431 9 13/16 2L432 8 7/8 2L433 8 5/8 2L434 7 7/8 2L435 7 3/4 2L421	10 1/16 2L531 9 5/8 2L532 9 7/16 2L533 8 7/8 2L534 8 1/16 2L535 7 3/4 2L521	10 1/16 2L631 9 13/16 2L632 9 7/16 2L633 9 1/16 2L634 8 7/16 2L622 8 1/16 2L624	9 15/16 2L682 9 9/16 2L683 9 1/4 2L684 8 3/4 2L674	8
103	Wear ring, casing	AISI Type 304 SS	4L103	4L167	4L168	4L101	4L102	4L103	4L167	—
184	Seal housing		1L112	1L118	1L122	1L115			1L114	3
203	Wear ring, seal hsg.		4L201	4L421		4L201			4L421	—
126	Shaft sleeve	AISI Type 300 SS	4K66							—
178	Impeller key		4K11							—
198	Impeller bolt		13K43							—
199	Impeller washer		13L39							—
108	Adapter for close-coupled (140JM-180JM)		Cast iron ASTM A48 CL 20	1L99	1L123	1L97			1L123	25
	Adapter for close-coupled (210JM motors)	1L98		1L100	1L96			1L100	29	
370	Casing bolting Hex bolt and nut	AISI Type 300 SS	13L89		13L86				—	
370	Adapter bolting adapter to motor (140JM-180JM)	Carbon St SAE 1200 series	13L43	13L117	13L43			13L177	—	
	Adapter bolting adapter to motor (210JM motors)		13K245	13K44	13K245			13K44	—	
383	Mechanical seal standard duty	Carbon/Ceramic	10K13							1/2
	Mechanical seal high temperature	Carbon/Ni-resist	10K19							
	Mechanical seal chemical duty	Carbon/Ceramic	10K25							
383A	Seal spring retainer	AISI Type 300 SS	4L45 (Replace with mechanical seal assembly.)							—
408	Drain plug 3/8 NPT		13L42							—
428	Impeller gasket set	Cellulose triacetate	5L73							—
513	O-ring-casing	BUNA-N	5L68		5L69				—	
	O-ring-casing (optional)	Viton	5L70		5L71				—	

Note: For Pricing refer to published Parts Price List using "L" or "K" number above.

# Pump End Parts For Close-Coupled With (250JM-360TCZ) And All Frame Mounted Configuration

For: M-Group power frame individual parts  
see M-Group Power Frame repair parts page.

Item No.	Description	Material	8" Impeller Models			10" Impeller Models					Max. Wt. (lbs.)	
			2 x 2 <sup>1</sup> / <sub>2</sub> -8	2 <sup>1</sup> / <sub>2</sub> x 3-8	3 x 4-8	1 <sup>1</sup> / <sub>4</sub> x 2-10	1 <sup>1</sup> / <sub>2</sub> x 2 <sup>1</sup> / <sub>2</sub> -10	2 x 2 <sup>1</sup> / <sub>2</sub> -10	2 <sup>1</sup> / <sub>2</sub> x 3-10	3 x 4-10		
			Part No.	Part No.	Part No.	Part No.	Part No.	Part No.	Part No.	Part No.		Part No.
100	Casing with wear ring	AISI Type 304 SS	1L109	1L110	1L111	1L101	1L102	1L103	1L105	1L107	17	
101	Impeller	AISI Type 304 SS  (Shaded areas are AISI Type 316 SS)	8 <sup>5</sup> / <sub>8</sub> 2L321	9 <sup>1</sup> / <sub>16</sub> 2L685	9 <sup>1</sup> / <sub>16</sub> 2L654	9 <sup>13</sup> / <sub>16</sub> 2L132	10 <sup>1</sup> / <sub>16</sub> 2L231	9 <sup>7</sup> / <sub>16</sub> 2L333	10 <sup>3</sup> / <sub>8</sub> 2L694	10 <sup>5</sup> / <sub>8</sub> 2L663	8	
			8 <sup>7</sup> / <sub>16</sub> 2L323	8 <sup>3</sup> / <sub>4</sub> 2L686	8 <sup>11</sup> / <sub>16</sub> 2L655	9 <sup>1</sup> / <sub>4</sub> 2L133	9 <sup>5</sup> / <sub>8</sub> 2L232	9 <sup>1</sup> / <sub>16</sub> 2L334	9 <sup>15</sup> / <sub>16</sub> 2L695	10 <sup>1</sup> / <sub>4</sub> 2L664		
			8 <sup>1</sup> / <sub>4</sub> 2L324	8 <sup>1</sup> / <sub>2</sub> 2L687	8 <sup>7</sup> / <sub>16</sub> 2L656	8 <sup>7</sup> / <sub>8</sub> 2L134	9 <sup>7</sup> / <sub>16</sub> 2L233	8 <sup>7</sup> / <sub>8</sub> 2L335	9 <sup>13</sup> / <sub>16</sub> 2L696	9 <sup>13</sup> / <sub>16</sub> 2L665		
			7 <sup>7</sup> / <sub>8</sub> 2L325	8 <sup>1</sup> / <sub>4</sub> 2L688	8 <sup>1</sup> / <sub>16</sub> 2L657	8 <sup>5</sup> / <sub>8</sub> 2L135	8 <sup>7</sup> / <sub>8</sub> 2L234	8 <sup>5</sup> / <sub>8</sub> 2L321	9 <sup>1</sup> / <sub>4</sub> 2L697	9 <sup>7</sup> / <sub>16</sub> 2L666		
			7 <sup>1</sup> / <sub>2</sub> 2L326	7 <sup>7</sup> / <sub>8</sub> 2L689	7 <sup>11</sup> / <sub>16</sub> 2L658	8 <sup>1</sup> / <sub>4</sub> 2L136	8 <sup>7</sup> / <sub>16</sub> 2L235	8 <sup>7</sup> / <sub>16</sub> 2L323	8 <sup>3</sup> / <sub>4</sub> 2L686	9 <sup>1</sup> / <sub>16</sub> 2L654		
			7 <sup>1</sup> / <sub>16</sub> 2L351	7 <sup>1</sup> / <sub>2</sub> 2L690	7 <sup>1</sup> / <sub>2</sub> 2L659	7 <sup>7</sup> / <sub>8</sub> 2L137	8 <sup>1</sup> / <sub>16</sub> 2L236	8 <sup>1</sup> / <sub>16</sub> 2L322		8 <sup>11</sup> / <sub>16</sub> 2L655		
			6 <sup>11</sup> / <sub>16</sub> 2L352	7 <sup>1</sup> / <sub>8</sub> 2L691	7 <sup>1</sup> / <sub>8</sub> 2L660	7 <sup>3</sup> / <sub>4</sub> 2L138	7 <sup>3</sup> / <sub>4</sub> 2L237					
			6 <sup>1</sup> / <sub>2</sub> 2L353	6 <sup>11</sup> / <sub>16</sub> 2L692	6 <sup>13</sup> / <sub>16</sub> 2L661							
					6 <sup>1</sup> / <sub>2</sub> 2L693	6 <sup>1</sup> / <sub>2</sub> 2L662						
			103	Wear ring, casing	AISI Type 304 SS	4L103	4L167	4L168	4L101	4L102		4L103
184	Seal housing	1L117	1L118	1L122		1L120			1L119	1L121	3	
203	Wear ring, seal hsg.	AISI Type 300 SS	4L201	4L424		4L201		4L421			—	
126	Shaft sleeve		4K262									—
178	Impeller key		4K261									—
198	Impeller bolt		13K155									—
199	Impeller washer		13L241									—
108	Adapter for power frame close-coupled (250JM motors)		Cast iron ASTM A48 CL 20	1L89		1L93	1L91		1L93	1L94		31
	Adapter for close-coupled (280JM-360TCZ)			1L88		1L92	1L90		1L92	1L95		44
370	Casing bolting Hex bolt and nut	AISI Type 300 SS	13L89		13L86						—	
370B	Adapter bolting adapter to bearing frame	Carbon/Steel	13L88		13L116	13L88		13L116			—	
371	Adapter bolting adapter to motor (250JM motors)		13L88		13L116	13L88		13L116			—	
	Adapter bolting adapter to motor (280JM-360TCZ)		13L87		13L115	13L87		3L115			—	
383	Mechanical seal standard duty	Carbon/Ceramic	10K16									1/2
	Mechanical seal high temperature	Carbon/Ni-resist	10K20									
	Mechanical seal chemical duty	Carbon/Ceramic	10K26									
383A	Seal spring retainer	AISI Type 300 SS	4L216 (Replace with mechanical seal assembly.)									—
408	Drain plug 3/8 NPT		13L42									—
428	Impeller gasket set	Cellulose triacetate	5L74									—
513	O-ring-casing	BUNA-N	5L68		5L69				4K244		—	
	O-ring-casing (optional)	Viton	5L70		5L71				5L72		—	

Note: For Pricing refer to published Parts Price List using "L" or "K" number above.



SPECIFICATIONS ARE SUBJECT TO CHANGE WITHOUT NOTICE.

PRINTED IN U.S.A.